

# CAM FOLLOWERS SCREWDRIVER SLOT HEAD

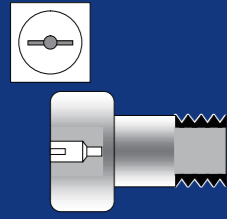

CF



CF.V

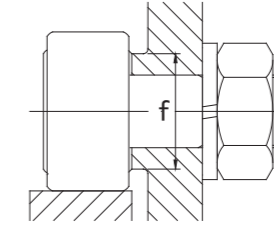
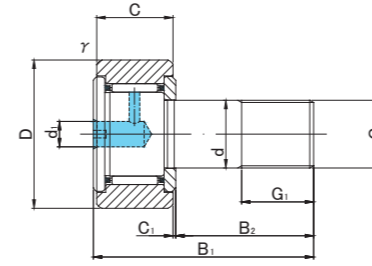

## CF TYPE

Prepacked Grease

Stud diameter (mm)	h7 tolerance	Designation				Dimensions (mm)												Basic dynamic load rating	Basic static load rating	Largest permissible load	Limiting speed *	Track load capacity		Max tightening torque	Mass
		Cylindrical outer ring		Crowned outer ring R250(CF5) R500(CF6 ~ CF10-1)		D	C	d	G	G1	B1	B2	C1	d1	r <sub>s</sub> min	f min	Cr N					Cor N	N		
5	0 -0.012	CF 5	CF 5UU	CF 5R	CF 5UUR	13	9	5	M5x0.8	7.5	23	13	0.5	3.1	0.3	9.7	3 140	2 770	1 420	29 000	2 250	530	2	10.5	
		CF 5V	CF 5VUU	CF 5VR	CF 5VUUR												5 100	5 500	1 420	11 600					
6	0 -0.012	CF 6	CF 6UU	CF 6R	CF 6UUR	16	11	6	M6x1	8	28	16	0.6	4	0.3	11	3 630	3 630	2 110	25 000	3 430	1 080	3	18.5	
		CF 6V	CF 6VUU	CF 6VR	CF 6VUUR												6 960	8 530	2 110	12 000					
8	0 -0.015	CF 8	CF 8UU	CF 8R	CF 8UUR	19	11	8	M8x1.25	10	32	20	0.6	4	0.3	13	4 310	4 710	4 710	20 000	4 020	1 370	8	28.5	
		CF 8V	CF 8VUU	CF 8VR	CF 8VUUR												8 130	11 170	4 710	9 000					
10	0 -0.015	CF10	CF10UU	CF10R	CF10UUR	22	12	10	M10x1.25	12	36	23	0.6	4	0.3	15	5 390	6 860	6 860	17 000	4 700	1 670	15	45	
		CF10V	CF10VUU	CF10VR	CF10VUUR												9 510	14 500	7 450	7 500					
10	0 -0.015	CF10-1	CF10-1UU	CF10-1R	CF10-1UUR	26	12	10	M10x1.25	12	36	23	0.6	4	0.3	15	5 390	6 860	6 860	17 000	5 490	2 060	15	60	
		CF10-1V	CF10-1VUU	CF10-1VR	CF10-1VUUR												9 510	14 500	7 450	7 500					

\* Without seals, suitable for grease lubrication. In case of oil lubrication, up to 130% of this value shall be permissible, and 70% of this value shall apply for types with seals.

### OUTER RINGS TOLERANCE

TYPE	Cylindrical outer ring	Crowned outer ring
CF5,CF6	0/-8	0/-50
CF8,CF10,CF10-1	0/-9	0/-50

### ACCESSORIES

TYPE	RESIN PLUG	NUT
CF5	—	Attached
CF6/CF8/CF10/CF10-1	φ 4 Attached	Attached