

CAM FOLLOWERS

HEXAGON SOCKET ON STUD HEAD

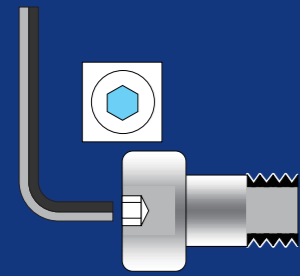

CF..A



CF..VA

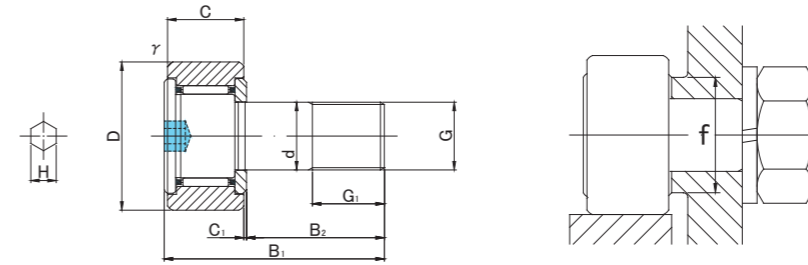

CF..A TYPE

Prepacked Grease

Stud diameter (mm)	h7 tolerance	Designation				Dimensions (mm)												Basic dynamic load rating Cr N	Basic static load rating Cor N	Largest permissible load N	Limiting speed * rpm	Track load capacity		Max tightening torque N·m	Mass g (approx)
		Cylindrical outer ring		Crowned outer ring R250(≤CF5) R500(CF6~CF10-1)		D	C	d	G	G1	B1	B2	C1	H	rs min	f min	Cylindrical outer ring N					Crowned outer ring N			
3	0 -0.010	CF 3A	CF 3UUA	CF 3RA	CF 3UURA	10	7	3	M3×0.5	5	17	9	0.5	2	0.2	6.8	1 470	1 180	360	47 000	1 370	370	0.4	4.5	
		CF 3VA	CF 3VUUA	CF 3VRA	CF 3VUURA												2 800	2 500	360	18 800					
4	0 -0.012	CF 4A	CF 4UUA	CF 4RA	CF 4UURA	12	8	4	M4×0.7	6	20	11	0.5	2.5	0.3	8.6	2 060	2 050	780	37 000	1 760	470	1	7.5	
		CF 4VA	CF 4VUUA	CF 4VRA	CF 4VUURA												4 000	4 300	780	14 800					
5	0 -0.012	CF 5A	CF 5UUA	CF 5RA	CF 5UURA	13	9	5	M5×0.8	7.5	23	13	0.5	3	0.3	9.7	3 140	2 770	1 420	29 000	2 250	530	2	10.5	
		CF 5VA	CF 5VUUA	CF 5VRA	CF 5VUURA												5 100	5 500	1 420	11 600					
6	0 -0.012	CF 6A	CF 6UUA	CF 6RA	CF 6UURA	16	11	6	M6×1	8	28	16	0.6	3	0.3	11	3 630	3 630	2 110	25 000	3 430	1 080	3	18.5	
		CF 6VA	CF 6VUUA	CF 6VRA	CF 6VUURA												6 960	8 530	2 110	12 000					
8	0 -0.015	CF 8A	CF 8UUA	CF 8RA	CF 8UURA	19	11	8	M8×1.25	10	32	20	0.6	4	0.3	13	4 310	4 710	4 710	20 000	4 020	1 370	8	28.5	
		CF 8VA	CF 8VUUA	CF 8VRA	CF 8VUURA												8 130	11 170	4 710	9 000					
10	0 -0.015	CF10A	CF10UUA	CF10RA	CF10UURA	22	12	10	M10×1.25	12	36	23	0.6	5	0.3	15	5 390	6 860	6 860	17 000	4 700	1 670	15	45	
		CF10VA	CF10VUUA	CF10VRA	CF10VUURA												9 510	14 500	7 450	7 500					
10	0 -0.015	CF10-1A	CF10-1UUA	CF10-1RA	CF10-1UURA	26	12	10	M10×1.25	12	36	23	0.6	5	0.3	15	5 390	6 860	6 860	17 000	5 490	2 060	15	60	
		CF10-1VA	CF10-1VUUA	CF10-1VRA	CF10-1VUURA												9 510	14 500	7 450	7 500					

* Without seals, suitable for grease lubrication. In case of oil lubrication, up to 130% of this value shall be permissible, and 70% of this value shall apply for types with seals.

OUTER RINGS TOLERANCE (μm)

TYPE	Cylindrical outer ring	Crowned outer ring
CF3,CF4,CF5,CF6	0/-8	0/-50
CF8,CF10,CF10-1	0/-9	0/-50

ACCESSORIES

TYPE	Image
CF3/CF4/CF5/CF6/CF8/CF10/CF10-1	 NUT Attached